

# 2018 NELSON DRIVE, TRF



Contact: Jeff Fagerstrom  
P.O. Box 421 - TRF - MN -56701  
681-2340

1,164 Square feet: House  
672 Square feet: Garage  
1,836 Total heated space

Plan Changes  
JF - 10-13-22

**BID SPECS:**  
2x6 Exterior walls  
1/16 OSB on exterior walls  
R-21 in wall cavity  
Vinyl siding  
Aluminum Soffit  
Steel Fascia  
15/32 OSB on roof  
30 yr Laminated Shingles  
Casement windows  
Natural Gas Boiler with hydronic floor heat  
Mini-split AC/Heat pump  
Garage finished (no Baseboard)

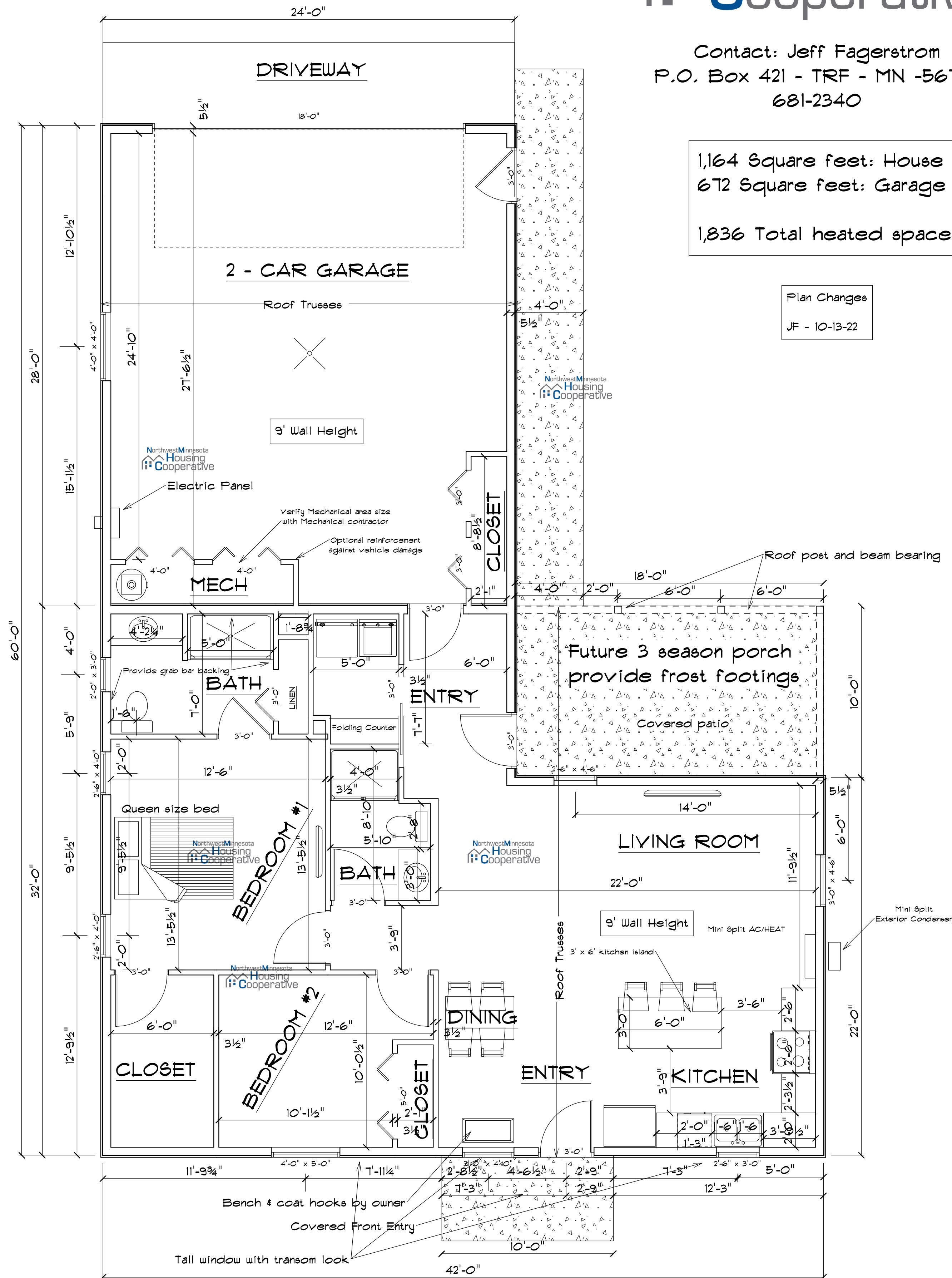

2018 NELSON DRIVE, TRF